

EAST ROAD

TOTAL DEPTH OF STORE 18.46 M

TOTAL WIDTH OF STORE 23.51 M

TESCO

ENTRANCE/EXIT

Shared Service Yard



REV	DATE	AMENDMENTS

ADDRESS: 172 E Rd
Cambridge, Cambridgeshire
CB1 1BG United Kingdom

FIRE DETECTION LEGEND

	SOUNDER
	VISUAL INDICATOR (BEACON)
	6KG 27A FOAM & 2KG CO2 EXTINGUISHERS
	AREA COVERED BY SMOKE DETECTIONS
	BREAK GLASS CALL POINT

RED LINE MEANING: The red line denotes the area of the premises to be licensed space

PROJECT:
CAMBRIDGE EAST RD

DESCRIPTION
PROPOSED SITE
BWS LICENSE LAYOUT

DRAWING NO. CAMBRIDGEFeaspg##BWSPLAN

PHASE 2 ISSUE ##

SYSTEM ID. No. CAMBRIDGEFeasbg##.dwg

SCALE DATE
NTS@A3 19.01.2024

PLANNING DEAN
MANAGER PREECE

TBS PLANNER MOHAMMED
AFLAH K H

TESCO
FEASIBILITY PLANNING
STORE PLANNING DEPARTMENT
PROPERTY SERVICES
HIGHWOODS BUILDING, KESTREL WAY
WELWYN GARDEN CITY, HERTFORDSHIRE, AL7 1GB UK
TELEPHONE : 01707 395150

THE COPYRIGHT AND ALL OTHER RIGHTS IN AND RELATING TO THIS PUBLICATION BELONG TO AND ARE THE SOLE PROPERTY OF TESCO STORES LIMITED. ALL RIGHTS ARE RESERVED. NEITHER THE WHOLE NOR ANY PART OF THIS PUBLICATION MAY BE REPRODUCED OR TRANSMITTED IN ANY FORM OR BY ANY ELECTRONIC OR MECHANICAL MEANS INCLUDING PHOTOCOPYING AND RECORDING OR FROM ANY RETRIEVAL SYSTEM WITHOUT THE PRIOR WRITTEN LICENCE FROM THE OWNER © 2019 TESCO STORES LIMITED.

EAST ROAD

TOTAL DEPTH OF STORE 18.46 M

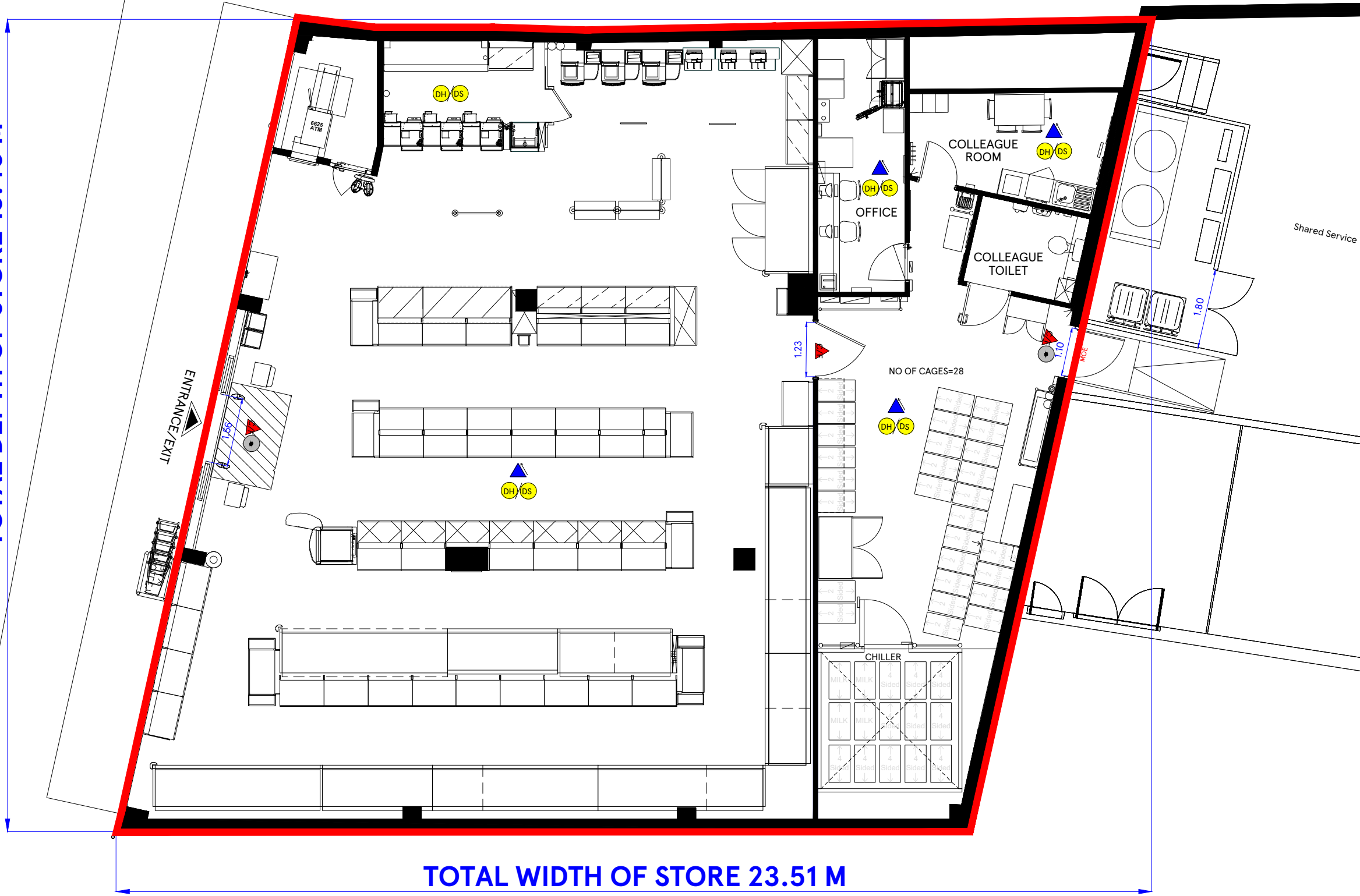

TOTAL WIDTH OF STORE 23.51 M

REV	DATE	AMENDMENTS

ADDRESS: 172 E Rd
Cambridge, Cambridgeshire
CB1 1BG United Kingdom

- FIRE DETECTION LEGEND**
- SOUNDER
 - VISUAL INDICATOR (BEACON)
 - 6KG 27A FOAM & 2KG CO2 EXTINGUISHERS
 - AREA COVERED BY SMOKE DETECTIONS
 - BREAK GLASS CALL POINT

RED LINE MEANING: The red line denotes the area of the premises to be licensed space

PROJECT:
CAMBRIDGE EAST RD

DESCRIPTION
PROPOSED RETAIL
BWS LICENSE LAYOUT

DRAWING NO. CAMBRIDGEFeasgag#BWSPLAN
PHASE 2 ISSUE ##

SYSTEM ID. No. CAMBRIDGEFeasg##.dwg
CAMBRIDGEFeasbg##.dwg

SCALE 1:100@A3 DATE 19.01.2024

PLANNING MANAGER DEAN PREECE

TBS PLANNER MOHAMMED AFLAH K H

TESCO
FEASIBILITY PLANNING
STORE PLANNING DEPARTMENT
PROPERTY SERVICES
HIGHWOODS BUILDING, KESTREL WAY
WELWYN GARDEN CITY, HERTFORDSHIRE, AL7 1GB UK
TELEPHONE : 01707 395150

THE COPYRIGHT AND ALL OTHER RIGHTS IN AND RELATING TO THIS PUBLICATION BELONG TO AND ARE THE SOLE PROPERTY OF TESCO STORES LIMITED. ALL RIGHTS ARE RESERVED. NEITHER THE WHOLE NOR ANY PART OF THIS PUBLICATION MAY BE REPRODUCED OR TRANSMITTED IN ANY FORM OR BY ANY ELECTRONIC OR MECHANICAL MEANS INCLUDING PHOTOCOPYING AND RECORDING OR FROM ANY RETRIEVAL SYSTEM WITHOUT THE PRIOR WRITTEN LICENCE FROM THE OWNER © TESCO STORES LIMITED.